

RESOLUTION NO. 27842

A RESOLUTION AUTHORIZING CLOVERDALE NEIGHBORHOOD ASSOCIATION C/O RICHARD BURKE TO USE TEMPORARILY THE RIGHT-OF-WAY LOCATED AT 4450 NORCROSS ROAD, 1505 CLOVERDALE ROAD, AND 1300 KOBLAN DRIVE FOR THE INSTALLATION OF THREE (3) NEIGHBORHOOD COMMUNITY MARKERS FOR IDENTIFICATION AT THE THREE (3) ENTRANCES OF THE CLOVERDALE NEIGHBORHOOD, AS SHOWN ON THE PHOTOS AND MAPS ATTACHED HERETO AND MADE A PART HEREOF BY REFERENCE, SUBJECT TO CERTAIN CONDITIONS.

---

BE IT RESOLVED BY THE CITY COUNCIL OF THE CITY OF CHATTANOOGA, TENNESSEE, That CLOVERDALE NEIGHBORHOOD ASSOCIATION C/O RICHARD BURKE, (hereinafter referred to as "Temporary User") be and is hereby permitted to use temporarily the right-of-way located at 4450 Norcross Road, 1505 Cloverdale Road, and 1300 Koblan Drive for the installation of three (3) neighborhood community markers for identification at the three (3) entrances of the Cloverdale neighborhood, as shown on the photos and maps attached hereto and made a part hereof by reference.

BE IT FURTHER RESOLVED, That said temporary usage shall be subject to the following conditions:

1. Temporary User may execute the Indemnification Agreement prior to the granting of a temporary use by the City Council provided that any obligation to Indemnify and hold the City of Chattanooga, its officers, agents and employees harmless for any claims for damages for injuries to persons or property shall be void if the Temporary Use is not granted to applicant by the Chattanooga City Council. Temporary User agrees to comply with all terms and conditions of the Indemnification Agreement in the event a temporary use is granted by the City Council.

2. Temporary User agrees to vacate the property and temporary use upon reasonable notice from the City to do so.

3. Temporary User shall provide adequate access for maintenance of any utilities located within the easement.

4. The location of each marker will be outside of the 25' sight triangle.

5. The location of each marker must be approved by Traffic Engineering before installation.

ADOPTED: April 22, 2014

/mem

## INDEMNIFICATION AGREEMENT

This Indemnification Agreement is entered into by and between THE CITY OF CHATTANOOGA, TENNESSEE (hereinafter the "City"), and CLOVERDALE NEIGHBORHOOD ASSOCIATION C/O RICHARD BURKE (hereinafter "Temporary User"), this 22nd day of April, 2014.

For and in consideration of the granting of the temporary usage of the right-of-way located at 4450 Norcross Road, 1505 Cloverdale Road, and 1300 Koblan Drive for the installation of three (3) neighborhood community markers for identification at the three (3) entrances of the Cloverdale neighborhood, as shown on the photos and maps attached hereto and made a part hereof by reference, the receipt of which is hereby acknowledged, Temporary User agrees as follows:

1. Temporary User may execute the Indemnification Agreement prior to the granting of a temporary use by the City Council provided that any obligation to Indemnify and hold the City of Chattanooga, its officers, agents and employees harmless for any claims for damages for injuries to persons or property shall be void if the Temporary Use is not granted to applicant by the Chattanooga City Council. Temporary User agrees to comply with all terms and conditions of the Indemnification Agreement in the event a temporary use is granted by the City Council.

2. Temporary User shall vacate the property and temporary use upon reasonable notice from the City to do so; the parties hereto agree that "reasonable notice" shall be deemed to be thirty (30) days. Temporary User shall restore the property to its original condition when it is returned to the City.

3. Temporary User shall provide adequate access for maintenance of any utilities located within the easement.

4. The location of each marker will be outside of the 25' sight triangle.

5. The location of each marker must be approved by Traffic Engineering before installation.

CLOVERDALE NEIGHBORHOOD  
ASSOCIATION

4/22/14, 2014  
Date

BY:   
Richard Burke

CITY OF CHATTANOOGA, TENNESSEE

4.22, 2014  
Date

BY:   
Andy Berke, Mayor

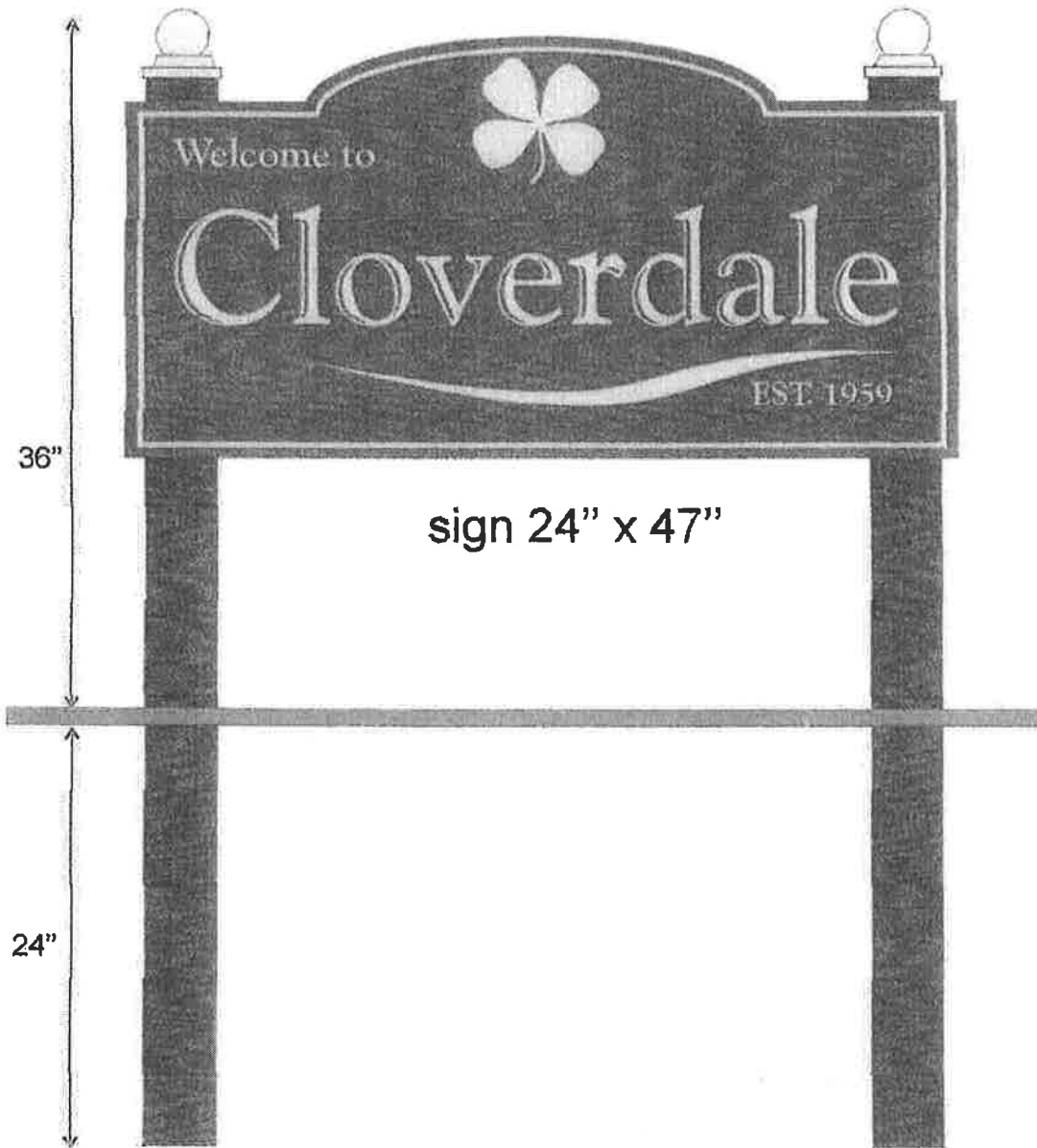

Qty 3  
Single Sided  
Routed PVC 1" THICK  
Dark green, gold and black post  
installed  
\$735.00 each





# Ed Gravitte Cloverdale Neighborhood Association

Temporary Usage: 4450 Norcross Rd, 1505 Cloverdale Dr, 1300 Koblan Dr

Community Markers at 3 locations within Cloverdale Neighborhood

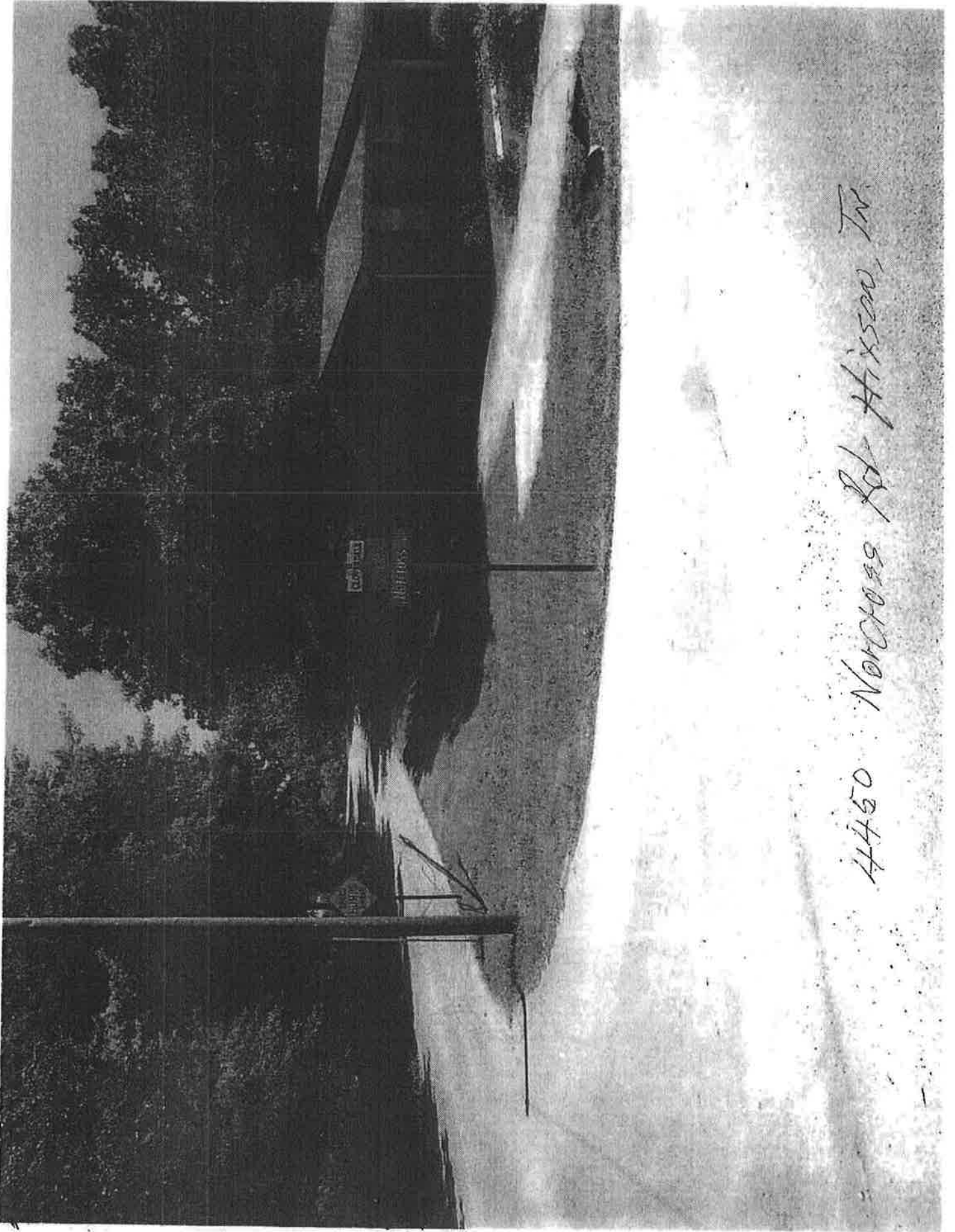

4450 Norcross Rd Hixson, TN

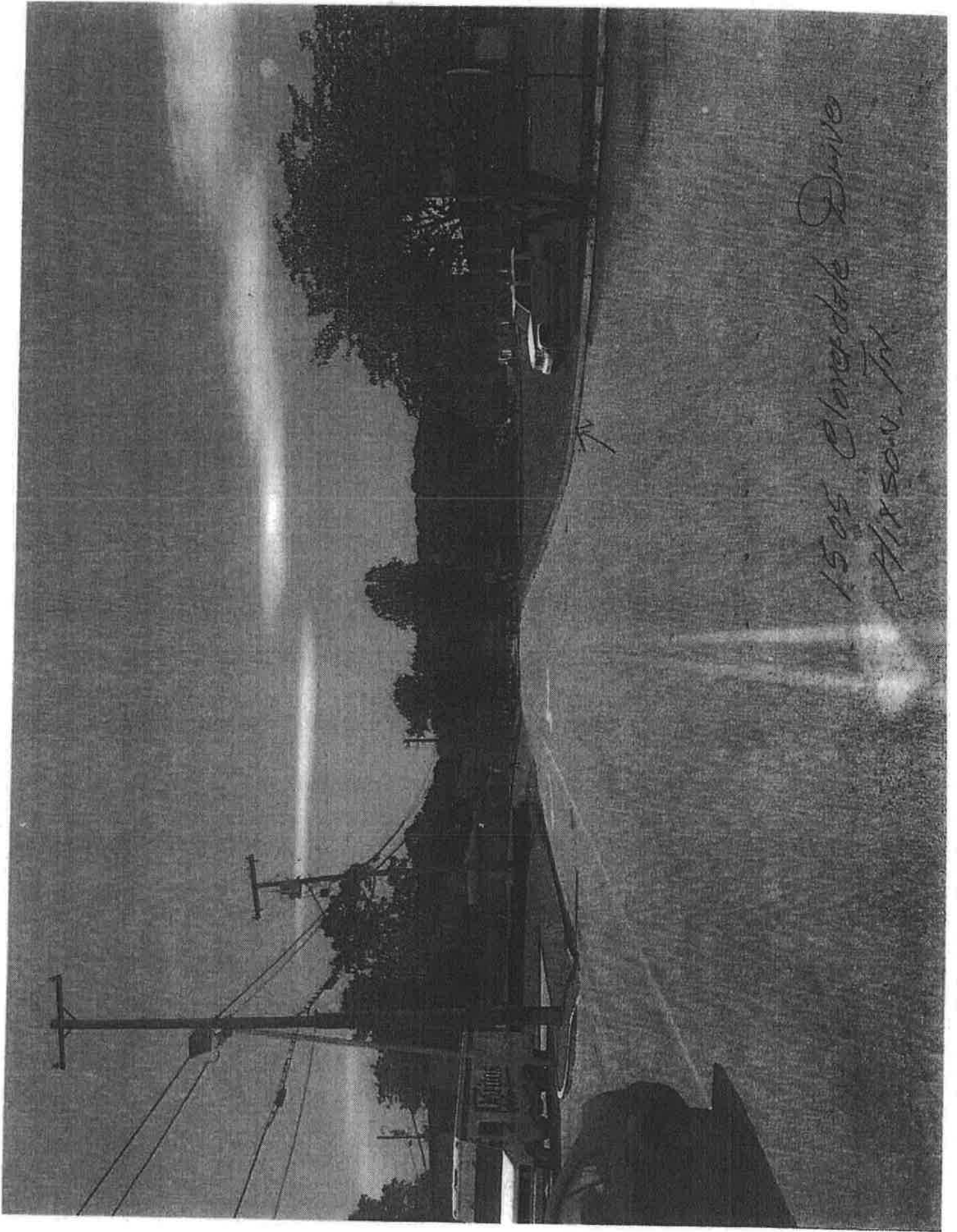

1505 Blomdale Drive  
Wilson, Pa





1300 Koblan Dr. Hixson, TN



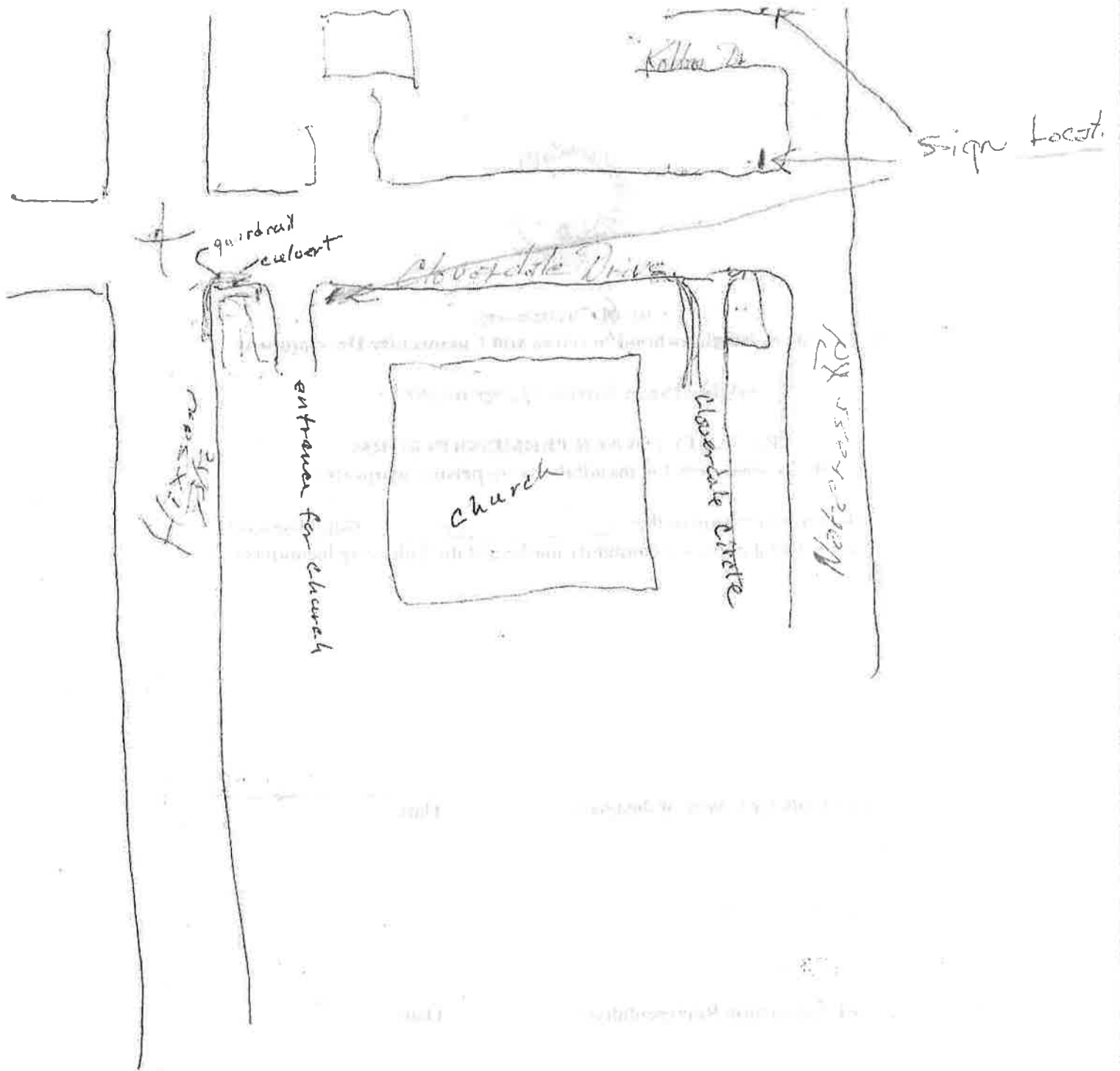

Kobbe Dr

Sign Locat.

quadrant alcove

Abbotsdale Drive

Hixson Rd

entrance for church

Church

closetable gate

Nottingham Rd